

Petite Homes

www.petite.homes



The Bachelor Pre-Fab

400 sqft ADU



Introducing The Bachelor Pre-Fab: comfortable, minimalist living with a small footprint.

With its clean lines, modern design, and sloped metal roof, The Bachelor effortlessly blends aesthetics and functionality to create a harmonious living space. The Bachelor's single-story layout offers 400 square feet of living area and double sliding doors to bring in plenty of natural light.

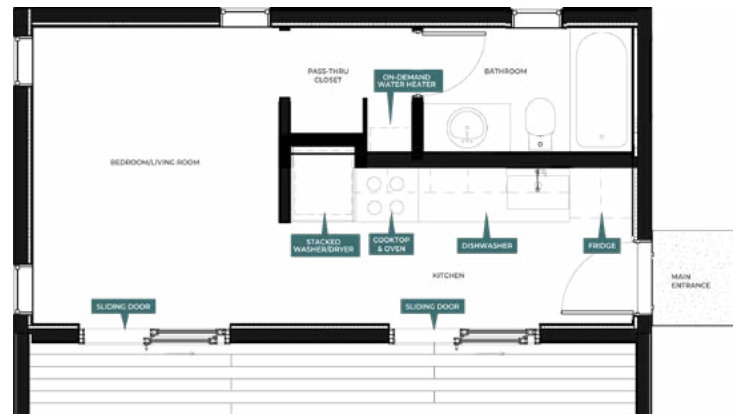

TO LEARN MORE OR TO CHECK YOUR PROPERTY'S ELIGIBILITY:
519-253-40 00 | hello@petite.homes | www.petite.homes



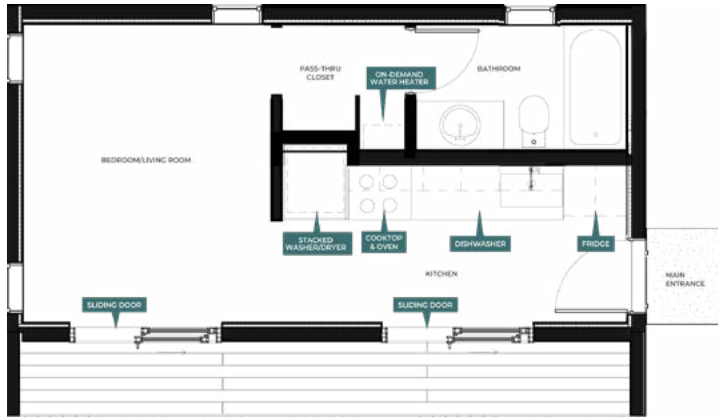

Exterior Dimensions: 25'W x 16'D X 10'2"H



The Bachelor Pre-Fab: Contractor-Ready or Move-In Ready

1 living/bedroom + 1 bath | 400 sqft | 1 story

We understand that some property owners already have a full team of contractors ready to go, and others don't. That's why we offer The Bachelor Pre-Fab in three models, depending on your needs.

One, Two, Three Ways to Build

SHELL

Factory-built Shell
On-Site Delivery
Installed on Your Foundation
Your Contractors Finish the Build

FOUNDATION

Factory-built and Delivered
Install of Concrete Foundation
Municipal Building Permits
Your Contractors Finish the Build

COMPLETE

Factory-built and Delivered
Install of Concrete Foundation
Utility Connections & Permits
Interior Fit & Finish
Heating / Air Conditioning

For current pricing, please visit www.petite.homes

Factory shell includes interior super structure, painted exterior siding, exterior doors, windows, metal roof, and decking. Furniture packages, appliance packages, and custom interior design options are available.

TO LEARN MORE OR TO CHECK YOUR PROPERTY'S ELIGIBILITY:
519-253-40 00 | hello@petite.homes | www.petite.homes

